

031

01.01, 01.02, 02.01, 01.05,
 01.06, 01.09, () 01.06
 () 102, 106, 108.
 12 18 10 (10).
 +500° () 1,0

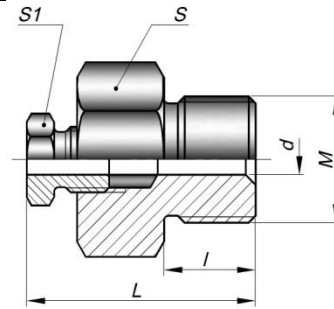

	L (max)	ℓ	M	d	S	S ₁
031.33-20- 10	67	18	33 2	20	41	36
031.27-20- 10	65	16	27 2	20	41	36
031.27-10- 10	50	16		10	32	22
031.20-10- 10	50	16	20 1.5	10	27	22
031.20-8- 10	48	16		8	27	22
031.20-6- 10	53	16		6	27	17
031.20-4,5- 10	47	16		5	27	17
031.20-3- 10	50	16		3	27	12
031.16-6- 10	49	12		16 1.5	6	22
031.16-4,5- 10	49	12	5		22	17
031.16-3- 10	46	12	3		22	12
031.12-6- 10	49	12	12 1.5	6	17	17
031.12-4,5- 10	49	12		5	17	17
031.12-3- 10	46	12		3	17	12
031.10 1-6- 10	47	10	10 1	6	17	17
031.10-4,5- 10;	47	10	10 1,5; 10 1	5	17	17
031.10-3- 10;	44	10	10 1,5; 10 1	3	17	12
031.8-4,5- 10	45	8	8 1	5	17	17
031.8-3- 10	42	8		3	14	12
031. 1/2-10- 10	55	21	1/2	10	24	22
031. 1/2-4,5- 10	58	21		5	24	17

031. È d ì 10,

10— 12 18 10 ,

, d .

: (—) .

041

01.01, 01.02, 02.01,
 01.05, 01.06, 01.09, () 01.06
 () 102, 106, 108.

10-6.

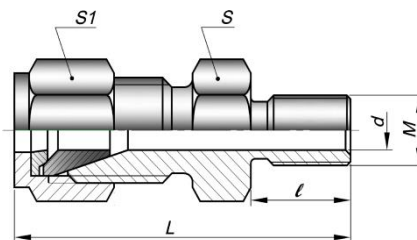

AISI 316SS.

: +600°

SS316

	100°	200°	300°	400°	500°	550°	575°	600°
6.3	5.4	4.5	4.0	3.7	3.6	3.2	3.0	2.5

	L	ℓ	M	d	S	S ₁	N,
041.33-20	67	24	33 2	20	41	35	6.3
041.27-20	62	20	27 2	20	36	35	
041.20-10	53	16	20 1.5	10	27	24	
041.16-4,5	43	14	16 1.5	4,5	22	14	
041.12-3	37	12	12 1.5	3	17	14	
041.8-4.5	37	12	8 1	4,5	14	14	

041. i d,
, d.

041.33-20 - 20 041, 33 2,

032

12 18 10 (10). (L)
(L), (L):
L = L . L .

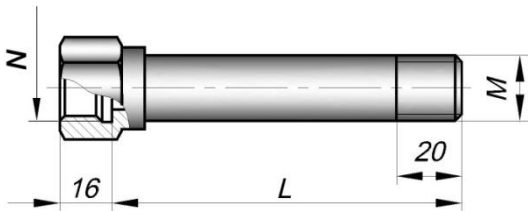

032. .N- 10 - L



016.33

L=40

032. .N- 10 - L,

, C₁₀. 12 18 10 , L.

032. 20. 20- 10-200— : 20 1,5,
12 18 10 (10), L=200 .